

## Multi Strand Stressing / Post Tensioning Jacks with Wedge Lock - Short Profile

Capacity 100 - 1500 ton | Stroke 200 mm | Working Pressure 600 bar



### Features / Application

- Pre-stressing & post tensioning of strands in concrete structure
- Safety Pressure Relief valve in return line
- Suitable calibrated power pack units & accessories available

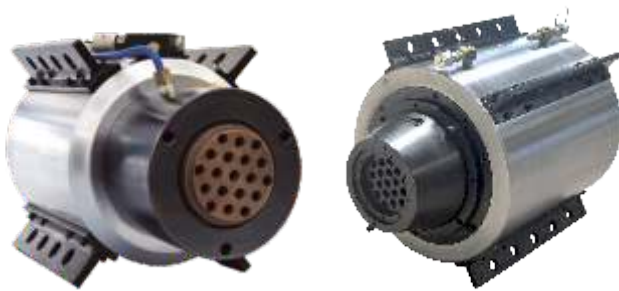

Customised

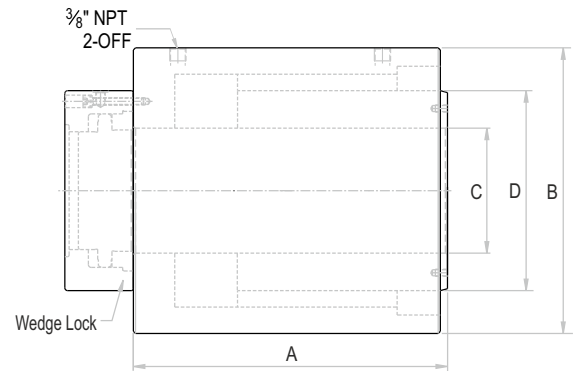

OMS Series - O Orione M Multi strand S Short profile 100 Capacity - ton 200 Stroke - mm

Rated capacity (ton)	Capacity @ 600 bar (kN)	Stroke (mm)	Model	Maximum No. of Strands		Effective area (cm <sup>2</sup> )	Oil Cap. (cc)	A Closed height (mm)	B Cylinder OD (mm)	C C'hole dia. (mm)	D Ram dia. (mm)	Wt. (Approx.) (kg.)
				0.5" Size	0.6" Size							
100	1181	200	OMS 100-200	7	5	196.9	3939	405	240	90	155	110
200	2200	200	OMS 200-200	12	7	366.8	7340	395	330	145	230	185
300	3561	200	OMS 300-200	19	12	593.5	11870	455	400	175	280	305
480	4675	200	OMS 480-200	31	19	779.1	15582	530	470	195	315	525
680	7521	200	OMS 680-200	42	27	1253.5	25070	570	580	240	360	845
1050	10576	200	OMS 1050-200	61	42	1762.6	35253	615	750	305	480	1670
1500	15781	200	OMS 1500-200	-	55	2630.1	52603	700	960	340	585	3300



### Power Pack Specification

Power pack Model	Pump Stage	Motor (HP / Phase)	Filling capacity (liters)	Pump flow (l/min)	Max. working pressure (bar)	Weight (Approx.) (kg.)	Operation
OPU007.5100	Single	5 / Three	80	2.6	700	195	Manual (Rotary DCV)

- Higher capacity & customized solutions on request.
- Specifications are subject to change due to continual improvement.
- Capacity & Stroke specified are maximum safe limits. As safe practice, use at 80% of rating.