

Low Height Jacks - Plain Ram, Single Acting, Plain / Spherical Saddle (Type - Spring Return)

Capacity 10 - 200 ton | Stroke 30 - 60 mm | Max. Working Pressure 700 bar



Features / Application

- Ideal for applications with low clearance
- Heavy equipment lifting & alignment
- **Ensure no gap between jack & load to be lifted, to utilize full stroke**

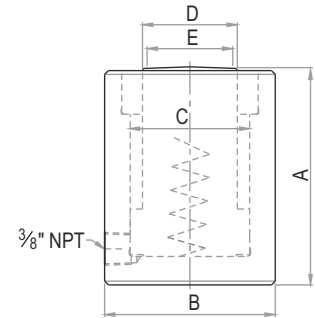

OSL Series - O Orione S Single acting Spring return L Low height Jack 10 Capacity - ton 30 Stroke - mm

Rated capacity (ton)	Capacity @ 700 bar (kN)	Stroke (mm)	Model	Effective area (cm ²)	Oil cap. (cc)	A Closed height (mm)	B Cylinder OD (mm)	C Bore dia. (mm)	D Ram dia. (mm)	E Saddle dia. (mm)	Wt. (Approx.) (kg)
10	111	30	OSL 10-30	15.9	48	90	70	45	35	-	2.3
20	218	50	OSL 20-50	31.2	160	115	90	63	50	-	4.9
30	309	50	OSL 30-50	44.2	221	120	100	75	60	-	6
50	550	60	OSL 50-60	78.5	471	125	130	100	80	60	11
75	792	60	OSL 75-60	113.1	679	145	155	120	95	70	18.4
100	1077	60	OSL 100-60	153.9	925	150	180	140	110	80	23.6
150	1589	60	OSL 150-60	227.0	1362	165	220	170	140	100	43
200	2199	60	OSL 200-60	314.2	1885	200	255	200	160	110	66



Features / Application

- Ideal for applications with low clearance
- Heavy equipment lifting & alignment
- Spherical saddle reduces damage to jack against off-center load
- **Ensure no gap between jack & load to be lifted, to utilize full stroke**

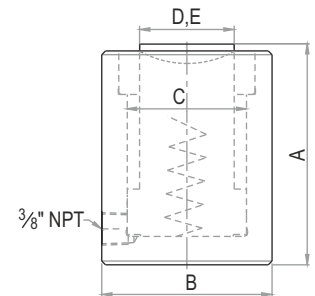

OSLS Series - O Orione S Single acting Spring return L Low height Jack S Spherical saddle (Tilting angle 5° Max.) 10 Capacity - ton 30 Stroke - mm

Rated capacity (ton)	Capacity @ 700 bar (kN)	Stroke (mm)	Model	Effective area (cm ²)	Oil cap. (cc)	A Closed height (mm)	B Cylinder OD (mm)	C Bore dia. (mm)	D Ram dia. (mm)	E Saddle dia. (mm)	Wt. (Approx.) (kg)
10	111	30	OSLS 10-30	15.9	48	110	70	45	35	35	2.5
20	218	50	OSLS 20-50	31.2	160	140	90	63	50	48	5.3
30	309	50	OSLS 30-50	44.2	221	145	100	75	60	55	6.5
50	550	60	OSLS 50-60	78.5	471	145	130	100	80	74	11.7
75	792	60	OSLS 75-60	113.1	679	170	155	120	95	88	19.8
100	1077	60	OSLS 100-60	153.9	925	175	180	140	110	100	25.2
150	1589	60	OSLS 150-60	227.0	1362	200	220	170	140	130	47
200	2199	60	OSLS 200-60	314.2	1885	235	255	200	160	150	71

- Higher capacity and customized solutions on request.
- Specifications are subject to change due to continual improvement.
- Capacity and Stroke specified are maximum safe limits. Use at 80% of rating as safe practice.