

Track Link Pin Presses - Tie Rod type (Removal / Installation)

Capacity 150 ton | Stroke 150 mm



Features / Application

- Removal & Installation of Track Link Pins & Bushes
- Maintenance of track chains in workshops & on sites
- Choice of toolings to suit range of track pins for all brands of Earth moving equipment
- Sprocket puller optional
- Guard for safe operation
- Box for storage

Toolings

Pin Removal / Installation

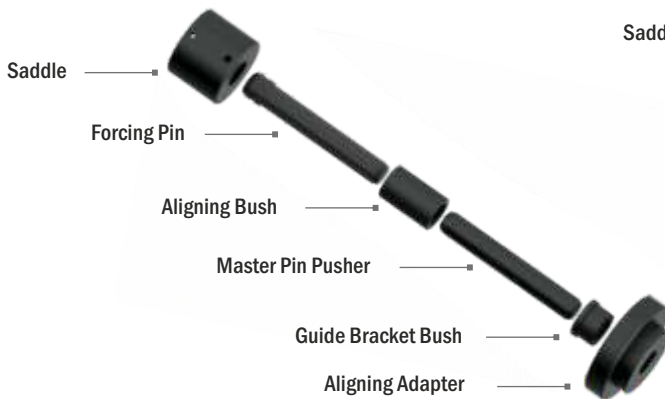

Bush Removal / Installation

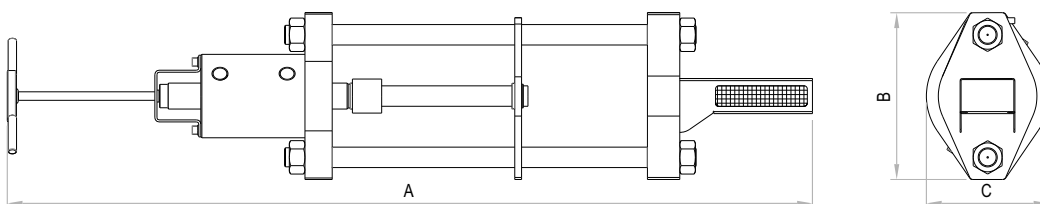
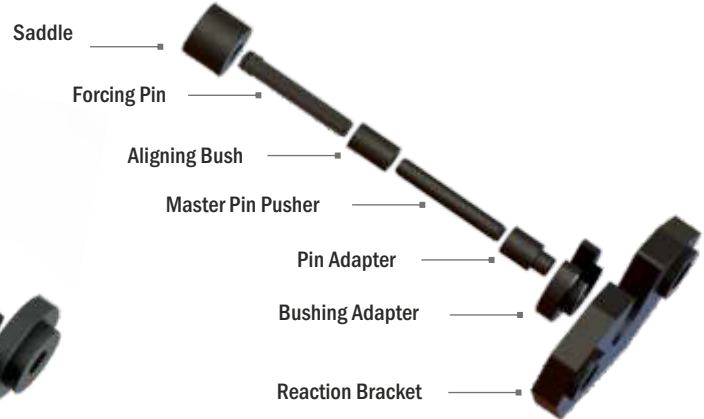

OTPP Series - O Orione T Track link P Pin P Pusher 150 Capacity - ton 150 Stroke - mm H Hollow Cylinder

Rated capacity (ton)	Capacity @ 700 bar (kN)	Stroke (mm)	Model	A Overall Length (mm)	B Height (mm)	C Width (mm)	Wt. (Approx.) (kg)	Pin dimensions		Suitable power pack
								Min. dia. (mm)	Max. dia. (mm)	
150	1649	150	OTPP 150-150H	2430	490	360	320	22	70	OPU003104 / OPU003103

Pumping Unit Specification

Power Pack (Model)	Pump Stage	Motor (HP / Phase)	Filling capacity (liters)	Pump Flow (l / min)	Working Pressure (bar)	Operation	Wt. (Approx.) (kg)
OPU003104	Single	3 / Single	20	1.5	650	Manual (Rotary DCV)	99
OPU003103	Single	3 / Three	20	1.5	650	Manual (Rotary DCV)	94

Note: Single Phase - 110 / 230 VAC, 50 Hz ; Three Phase - 415 VAC, 50 Hz

- Higher capacity and customized solutions on request.
- Specifications are subject to change due to continual improvement.
- Capacity and Stroke specified are maximum safe limits. As safe practice, use at 80% of rating.