

## Span Lifting Jacks - Threaded Ram with Safety Lock Nut, Single Acting, Spherical Saddle with Gland Nut / Ram Stopper (Type - Spring Return)

Capacity 200 - 500 ton | Stroke 40 - 100 mm | Max. Working Pressure 700 bar

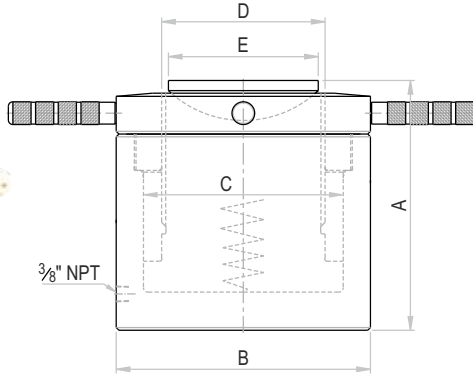

### Features/Application

- Ideally suited where space is limited
- Spherical saddle reduces damage to jack against off-center load
- Lifting application requiring sustained load holding in Infrastructure projects & heavy fabrication
- Ensure no gap between jack & load to be lifted, to utilize full stroke

**CSTS Series - C Customised S Single acting Spring return T Threaded ram S Spherical saddle (Tilting angle 5° Max.)**  
**200 Capacity - ton 50 Stroke - mm**

Rated capacity (ton)	Capacity @ 700 bar (kN)	Stroke (mm)	Model	Effective area (cm <sup>2</sup> )	Oil cap. (cc)	A Closed height (mm)	B Cylinder OD (mm)	C Bore dia. (mm)	D Ram dia. (mm)	E Saddle dia. (mm)	Wt. (Approx.) (kg)
200	2199	50	CSTS 200-50	314.2	1571	220	255	200	160	150	78
250	2661	45	CSTS 250-45	380.1	1711	220	280	220	180	165	98
250	2661	75	CSTS 250-75	380.1	2851	250	280	220	180	165	109
250	2661	100	CSTS 250-100	380.1	3801	275	280	220	180	165	118
300	3167	100	CSTS 300-100	452.4	4524	290	310	240	200	180	162
400	4242	40	CSTS 400-40	706.9	2827	235	400	300	250	230	220
500	4948	50	CSTS 500-50	706.9	3534	320	400	300	250	230	310

## Pancake Jacks - Threaded Ram with Safety Lock Nut, Single Acting, **OLTVL** Spherical Saddle Without Gland Nut / Ram Stopper (Type - Load Return)

Capacity 50 - 1200 ton | Stroke 45 - 50 mm | Max. Working Pressure 700 bar

**OLTVL Series - O Orione L Single acting Load return T Threaded ram VL Very Low height 50 Capacity - ton 50 Stroke - mm**

Rated capacity (ton)	Capacity @ 700 bar (kN)	Stroke (mm)	Model	Effective area (cm <sup>2</sup> )	Oil cap. (cc)	A Closed height (mm)	B Cylinder OD (mm)	C Bore dia. (mm)	D Ram dia. (mm)	E Saddle dia. (mm)	Saddle max. tilt angle	Wt. (Approx.) (kg)
50	550	50	OLTVL 50-50	78.5	393	125	140	100	100	90	5°	15
100	1077	50	OLTVL 100-50	153.9	770	140	180	140	140	125	5°	28.5
150	1589	45	OLTVL 150-45	227.0	1022	150	220	170	170	160	5°	44
200	2199	45	OLTVL 200-45	314.2	1414	155	255	200	200	180	5°	61
250	2661	45	OLTVL 250-45	380.1	1710	160	280	220	220	200	5°	76
300	3167	45	OLTVL 300-45	452.4	2036	170	310	240	240	220	4°	99
400	4008	45	OLTVL 400-45	572.6	2577	180	350	270	270	250	4°	130
500	4948	45	OLTVL 500-45	706.9	3181	195	400	300	300	290	3°	185
800	7939	45	OLTVL 800-45	1134.1	5104	245	505	380	380	340	3°	369
1000	9930	45	OLTVL 1000-45	1418.6	6384	260	560	425	425	380	3°	477
1200	12405	45	OLTVL 1200-45	1772.1	7974	280	600	475	475	400	3°	597

- Higher capacity and customized solutions on request.
- Specifications are subject to change due to continual improvement.
- Capacity and Stroke specified are maximum safe limits. As safe practice, use at 80% of rating.