

# ODP



## Multipurpose Jacks - Plain Ram, Double Acting (Type - Oil Return)

Capacity 10 - 400 ton | Stroke 150 mm | Max. Working Pressure 700 bar



### Features / Application

- Suits general lifting & push-pull applications
- Safety Pressure Relief valve in return port prevents damage, in case of accidental over-pressurization due to blockage in return line
- Base mounting holes & collar threads are optional
- Pile load testing, box pushing, ship lifting & hydraulic presses

**Note:** Refer Page 30 for Mounting Details



Customised

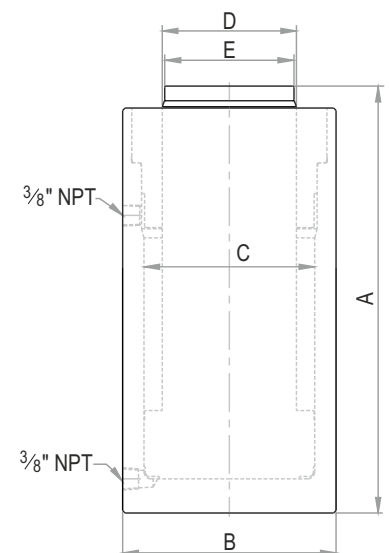

ODP Series - O Orione D Double acting Oil return P Plain ram 10 Capacity - ton 150 Stroke - mm

Rated capacity (ton)	Capacity @ 700 bar (kN)	Stroke (mm)	Model	Effective area (cm <sup>2</sup> )	Oil cap. (cc)	A Closed height (mm)	B Cylinder OD (mm)	C Bore dia. (mm)	D Ram dia. (mm)	E Saddle dia. (mm)	Wt. (Approx.) (kg)
10	111	150	ODP 10-150	15.9	239	275	75	45	30	28	8
15	167	150	ODP 15-150	23.8	356	280	85	55	40	38	11
20	218	150	ODP 20-150	31.2	468	285	95	63	50	48	14
25	270	150	ODP 25-150	38.5	577	295	95	70	55	53	14.3
30	309	150	ODP 30-150	44.2	663	305	100	75	55	53	15.6
50	550	150	ODP 50-150	78.5	1178	305	130	100	70	67	26.3
75	792	150	ODP 75-150	113.1	1696	305	155	120	90	87	38.5
100	1077	150	ODP 100-150	153.9	2309	310	180	140	110	106	53.5
150	1589	150	ODP 150-150	227.0	3405	320	220	170	140	137	84
200	2199	150	ODP 200-150	314.2	4712	345	255	200	150	146	116
250	2661	150	ODP 250-150	380.1	5702	350	280	220	180	177	148
300	3167	150	ODP 300-150	452.4	6786	365	310	240	180	177	181
400	4008	150	ODP 400-150	572.6	8588	385	350	270	220	216	255

- Higher capacity and customized solutions on request.
- Specifications are subject to change due to continual improvement.
- Capacity and Stroke specified are maximum safe limits. Use at 80% of rating as safe practice.

## Multipurpose Jacks - Plain Ram, Double Acting, Spherical Saddle (Type - Oil Return)

Capacity 10 - 2000 ton | Stroke 150 mm | Max. Working Pressure 700 bar



### Features / Application

- Suits general lifting & push-pull application
- Safety Pressure Relief valve in return port prevents damage, in case of accidental over-pressurization due to blockage in return line
- Spherical saddle reduces damage to jack against off-center load
- Base mounting holes & collar threads are optional
- Pile load testing, box pushing, ship lifting & hydraulic presses



**Note:** Refer Page 30 for Mounting Details



Customised

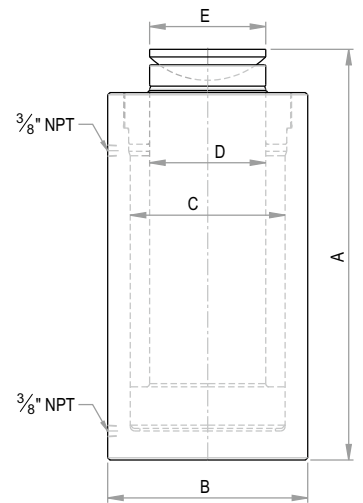

**ODPS Series - O** Orione **D** Double acting **O**il return **P** Plain ram **S** Spherical saddle (Tilting angle 5° Max.) **10** Capacity - ton **150** Stroke - mm

Rated capacity (ton)	Capacity @ 700 bar (kN)	Stroke (mm)	Model	Effective area (cm <sup>2</sup> )	Oil cap. (cc)	A Closed height (mm)	B Cylinder OD (mm)	C Bore dia. (mm)	D Ram dia. (mm)	E Saddle dia. (mm)	Wt. (Approx.) (kg)
10	111	150	ODPS 10-150	15.9	239	285	75	45	30	35	8.3
15	167	150	ODPS 15-150	23.8	356	290	85	55	40	35	11.3
20	218	150	ODPS 20-150	31.2	468	300	95	63	50	48	14.6
25	270	150	ODPS-25-150	38.5	577	310	95	70	55	48	14.8
30	309	150	ODPS 30-150	44.2	663	320	100	75	55	55	16.5
50	550	150	ODPS 50-150	78.5	1178	320	130	100	70	74	27
75	792	150	ODPS 75-150	113.1	1696	330	155	120	90	88	40
100	1077	150	ODPS 100-150	153.9	2309	330	180	140	110	100	54.5
150	1589	150	ODPS 150-150	227.0	3405	345	220	170	140	130	87
200	2199	150	ODPS 200-150	314.2	4712	370	255	200	150	150	119.5
250	2661	150	ODPS 250-150	380.1	5702	385	280	220	180	165	153
300	3167	150	ODPS 300-150	452.4	6786	400	310	240	180	180	189
400	4008	150	ODPS 400-150	572.6	8588	425	350	270	220	212	265
500	4948	150	ODPS 500-150	706.9	10603	450	400	300	240	230	367
600	5987	150	ODPS 600-150	855.3	12829	480	430	330	270	260	453
800	7939	150	ODPS 800-150	1134.1	17012	515	505	380	300	290	655
1000	9930	150	ODPS 1000-150	1418.6	21279	560	560	425	350	330	896
1500	15154	150	ODPS 1500-150	2164.8	32472	620	705	525	420	400	1543
2000	20458	150	ODPS 2000-150	2922.5	43837	705	810	610	525	495	2366

- Higher capacity and customized solutions on request.
- Specifications are subject to change due to continual improvement.
- Capacity and Stroke specified are maximum safe limits. Use at 80% of rating as safe practice.